

# NORTH POINT CABINETS®



Thoughtfully Designed, Carefully Crafted



## The NorthPoint Cabinetry Solution

NorthPoint Cabinetry features a wide array of **QuickBuild**® cabinet designs, providing value with a quality, custom look. Cabinets are in stock, shipping quickly from our strategically located warehouses across the U.S.

- Unique dovetail and pocket screw cabinet construction for sturdy and fast assembly
- Robust replacement parts program
- Free freight on most orders
- Dedicated customer service support



For more information, visit [NorthPointCabinetry.com](https://www.northpointcabinetry.com) or scan the QR code.

With 6 dedicated warehouses across the country, NorthPoint Cabinetry typically ships within 48 hours and arrives in 2–3 business days.

# The Quick Advantage

## Ships QUICKLY, Assembles FAST

NorthPoint Cabinetry offers a **quick** advantage for you and your customer by making it fast and easy to design, order, ship & assemble cabinets. *Why does this matter?* With a reduction in time and labor, you can complete more jobs and see significant savings.

Some specific ways the NorthPoint Cabinetry Quick Advantage can save you time & money:

- **Quick to Design**

Our cabinets are available in 2020 and ProKitchen software, making kitchen design fast and easy.



- **Quick to Order**

Place an order for your cabinets with our quoting tool, on our website at NorthPointCabinetry.com, or by contacting a live customer service agent.

- **Quick to Ship**

With 6 dedicated warehouses across the country, orders typically ship within 48 hours and arrive in 2–3 business days.

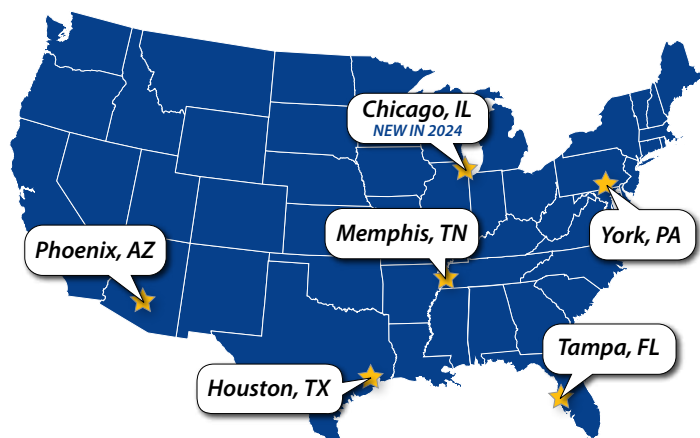

- **Quick to Assemble**

With our **QuickBuild**® cabinets, the average assembly time per cabinet is 8 minutes\*; you can build a medium-sized kitchen in less than half a day.

\*Specialty cabinets may take longer than average to assemble.

# Quality Comes First

---

You can trust NorthPoint Cabinetry for your customers. Our cabinets and hardware have gone through rigorous third-party testing and meet the KCMA standards. With quality details throughout and the features your customer will appreciate, NorthPoint Cabinetry is built to last.



## It Starts with Quality Wood

Just as a healthy tree needs strong roots to thrive, a quality cabinet requires premium lumber at its core. The quality of wood is of utmost importance, so our cabinets feature all-wood construction.

## Structural Integrity

Meaningful yet hidden reinforcements—like solid wood corner blocks and strategically placed pocket screws—help reinforce the structural integrity of the cabinet. Take comfort that these well-constructed cabinets will stand the test of time.



## Thoughtful Craftsmanship

These cleverly designed cabinets boast an innovative dovetail and hidden pocket screw construction that provides robust quality and quick, accurate assembly.



## Pretty on the Inside, Too

NorthPoint Cabinetry features a clean and beautifully finished birch interior that enhances the cabinet's luxurious, high-quality appeal.

## Premium Drawer Boxes

Dovetail joinery is the hallmark of high-quality drawer boxes. The UV finish of the drawer boxes coupled with the dovetail construction, and smooth concealed slides are synonymous with quality furniture.



## Hardworking Hardware

Our cabinets feature discreet compact hinges and concealed undermount slides. The hinges and slides have been third-party tested and exceed industry standards. The Premier Collection (shown) features full extension slides, allowing for easy access and use of the whole drawer.

## Sturdy Shelves

NorthPoint Cabinetry shelves are constructed from an impressive  $\frac{3}{4}$ " thick veneered plywood, preventing sagging over time under the weight of normal use. Shelf height is adjustable, so the homeowner can optimize storage space.



# Expert Finishing

---

Count on consistent, high-quality finishing. Our state-of-the-art manufacturing facility utilizes a multi-step professional finishing process. This meticulous process maintains a high degree of color and application accuracy from cabinet to cabinet, ensuring a beautiful run of cabinets when installed.



ESPRESSO  
(STAINED)



SLATE  
(STAINED)



PEBBLE GREY  
(PAINTED)



POLAR WHITE  
(PAINTED)

# What are **QuickBuild**<sup>®</sup> Cabinets?



## **Dovetail + Pocket Screws = QuickBuild**<sup>®</sup>

Basic assembly of our cabinets is as simple as sliding the panels together and securing with pocket screws. You don't need extra fasteners to hold the panels in place, and conveniently placed pocket screws will reduce the average time you spend on each cabinet.



### **How fast can you build a cabinet?**

One of our cabinets takes about 8 minutes\* to assemble (many do it in 4). You can build a kitchen or bathroom in record time!



Scan the QR code or go to <https://delivr.com/2kcwh> to view our Quick Assembly Video.

\*Specialty cabinets may take longer than average to assemble.

# Our Collections



## PREMIER Collection

The Premier Collection features elegant upgrades like soft-close doors and drawers.

### Door Styles: Catalina, Maui

- 3/4" solid wood face frame & shelves
- 1/2" plywood cabinet construction
- Beautiful, finished interior
- 5-Year limited lifetime warranty







# ESSENTIALS

Collection

The Essentials Collection delivers on style at an impressive value.

## Door Style: Hatteras

- 3/4" solid wood face frame & shelves
- 1/2" plywood cabinet construction
- Beautiful, finished interior
- 1-Year limited lifetime warranty

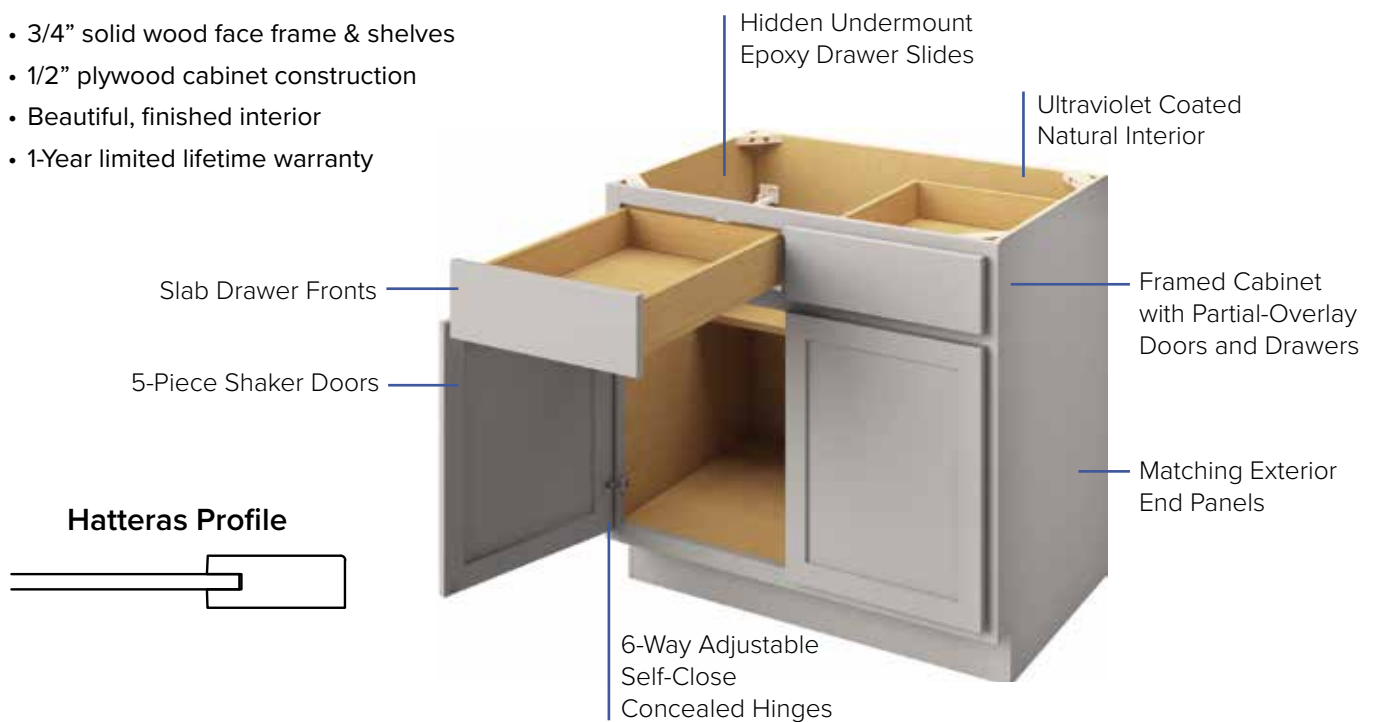

# PREMIER COLLECTION: CATALINA



Cabinets Shown in Catalina Pebble Grey  
Decorative Cabinet Hardware: Katharine Collection in Brushed Pewter



## CATALINA FINISHES

---

More than modern. The Catalina door style features a full-overlay, Shaker style door and 5-piece drawer front.



POLAR WHITE



PEBBLE GREY



ESPRESSO



SLATE



# PREMIER COLLECTION: MAUI



Cabinets Shown in Maui Polar White; Island Shown in Maui Espresso  
Decorative Cabinet Hardware: Zane Collection in Polished Chrome



## MAUI FINISHES

---

Sometimes the details make all the difference. The Maui door style features a full-overlay, transitional style door and 5-piece drawer front with a twist of character.



POLAR WHITE



PEBBLE GREY



ESPRESSO



SLATE



# ESSENTIALS COLLECTION: HATTERAS



Cabinets Shown in Hatteras Slate  
Decorative Cabinet Hardware: William Collection in Satin Nickel



## HATTERAS FINISHES

---

Simple and sleek. The Hatteras door style features a partial-overlay, Shaker-style door and slab drawer front.



POLAR WHITE



PEBBLE GREY



ESPRESSO



**NEW** SLATE



# Cabinets for Any Space

---

The kitchen and bath are common spaces to install cabinetry. However, NorthPoint Cabinetry provides solutions for other spaces like the laundry room, mudroom, and entertainment areas. Cabinets make those areas more functional by providing additional storage and countertop work space.



## Wine Bar

Catalina Pebble Grey Cabinets  
Decorative Cabinet Hardware: Marlo in Satin Nickel





## Mudroom

Maui Polar White Cabinets  
Decorative Cabinet Hardware:  
Ella Collection in Brushed Oil  
Rubbed Bronze  
Decorative Hooks:  
Emerald in Brushed Oil  
Rubbed Bronze



## Laundry Room

Catalina Slate Cabinets  
Decorative Cabinet Hardware:  
Hudson Collection  
in Satin Nickel

# Cabinet Lineup

## WALL CABINETS

12" deep except where noted  
 42" high wall cabinets will have 3 shelves  
 \*39" and 42" widths will have a vertical center stile unless otherwise noted

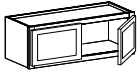

**Double Door**  
 12" Height  
 30", 33", 36",  
 or \*39" Width

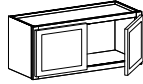

**Double Door**  
 15" Height  
 30", 33", 36",  
 or \*39" Width

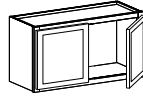

**Double Door**  
 18" Height  
 21", 24", 30", 33", 36",  
 or \*39" Width

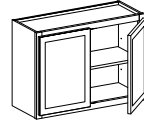

**Double Door**  
 24" Height  
 30", 33", 36", or \*39" Width

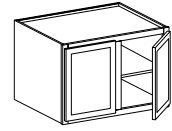

**Deep Double Door**  
 18" or 24" Height • 24" Depth  
 36" or \*39" Width  
 18" Height does not have shelf

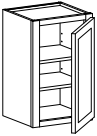

**Single Door**  
 30" Height  
 9", 12", 15", 18", or 21" Width

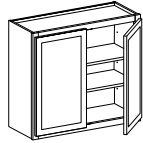

**Double Door**  
 30" Height  
 24", 27", 30", 33",  
 36", \*39", or \*42" Width

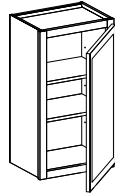

**Single Door**  
 36" Height  
 9", 12", 15", 18", or 21" Width

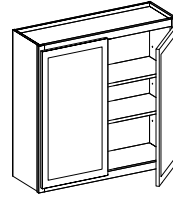

**Double Door**  
 36" Height  
 24", 27", 30", 33",  
 36", \*39", or \*42" Width

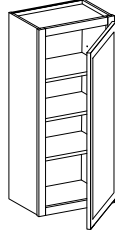

**Single Door**  
 42" Height  
 9", 12", 15", 18", or 21" Width

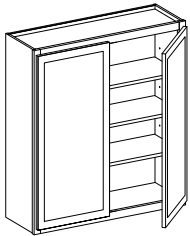

**Double Door**  
 42" Height  
 24", 27", 30", 33",  
 36", \*39", or \*42" Width

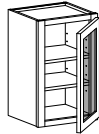

**Single & Double Glass Door**  
 Matching Finish Color Interior  
 30" Height  
 15", 18", 30", or 36" Width

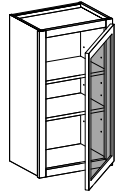

**Single & Double Glass Door**  
 Matching Finish Color Interior  
 36" Height  
 15", 18", 30", or 36" Width

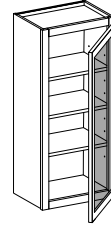

**Single & Double Glass Door**  
 Matching Finish Color Interior  
 42" Height  
 15", 18", 30", or 36" Width

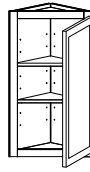

**Wall End Single Door**  
 30", 36", or 42" Height  
 12" Width

*Glass door wall cabinets only available in the Premier Collection*

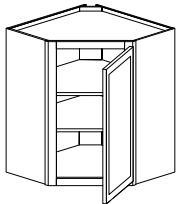

**Diagonal Corner**  
 30", 36", or 42" Height  
 12 or 15" Depth  
 24" or 27" Width

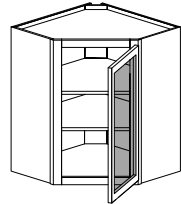

**Diagonal Corner Glass Door**  
 Matching Finish Color Interior  
 30", 36" or 42" Height  
 12 or 15" Depth  
 24" or 27" Width

*Glass door wall cabinets only available in the Premier Collection*

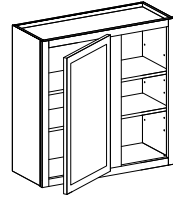

**Universal Blind Corner**  
 30", 36", or 42" Height  
 30"-33" Width

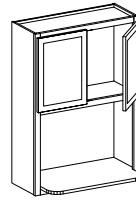

**Microwave Wall Cabinet**  
 Extended Shelf  
 36" Height  
 30" Width

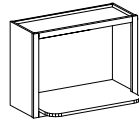

**Microwave Wall Cabinet**  
 Extended Shelf  
 18" Height  
 30" Width

## BASE CABINETS

24" deep, 34-1/2" high  
 except where noted

\*39" and 42" widths will  
 have a vertical center stile  
 unless otherwise noted

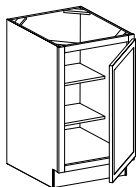

**Full Height  
 Single Door**  
 9", 12", 15", or 18" Width

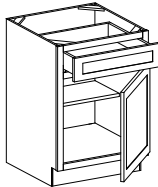

**Single Door  
 and Drawer**  
 12", 15", 18", or 21" Width

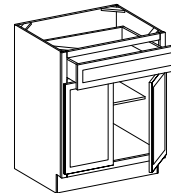

**Double Door and  
 Single Drawer**  
 24", 27", or 30" Width

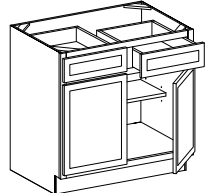

**Double Door and  
 Double Drawer**  
 33", 36", \*39", or \*42" Width

# Thousands of Cabinet Options in Stock for Quick Delivery

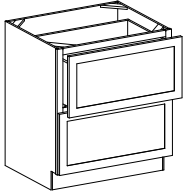

**Double Drawer**  
30" or 36" Width

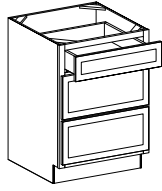

**Triple Drawer**  
12", 15", 18", 21", 24", 30",  
or 36" Width

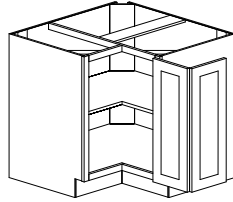

**Base Corner Cabinet**  
33" or 36" Width  
(Lazy Susan inserts available)

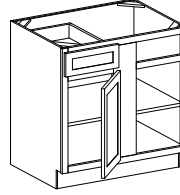

**Universal Blind  
Base Corner**  
39"-42", 42"-45", or  
45"-48" Width

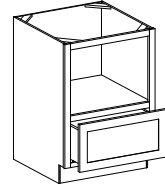

**Microwave Base  
Cabinet with Drawer**  
30" Width

## SINK BASE CABINETS

24" deep, 34-1/2" high  
except where noted.

\*39" and 42" widths will  
have a vertical center stile  
unless otherwise noted

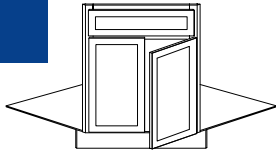

**Corner Sink Front  
Double Door**  
24" Depth  
(2-piece bottom panel)

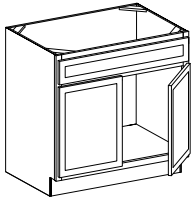

**Sink Base  
Double Door**  
30", 33", 36", or 39" Width

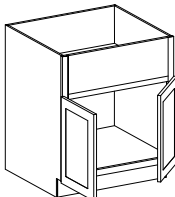

**Farmhouse Sink  
Base Double Door**  
36" or 39" Width  
(No center stile)

## TALL CABINETS

24" deep except  
where noted.

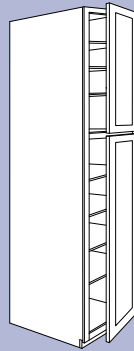

**Utility/Pantry  
Single Door**  
84", 90" (6 shelves),  
or 96" Height (7 shelves)  
18" Width

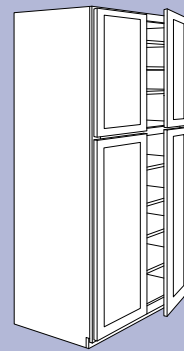

**Utility/Pantry  
Double Door**  
84", 90" (6 shelves),  
or 96" Height (7 shelves)  
24" or 30" Width

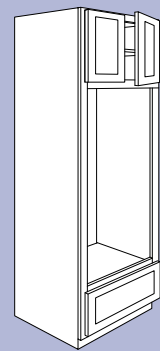

**Oven Double Door,  
Single Drawer**  
84", 90", or "96" Height  
33" Width  
\*Single shelf in 96" only  
(Double Oven Overlay Panel available)

## VANITY CABINETS

21" deep, 34-1/2" high  
except where noted

\*42" widths will have a  
vertical center stile

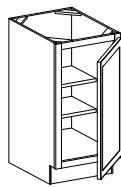

**Single Door**  
12" Width

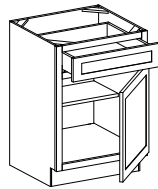

**Single Door  
and Drawer**  
12", 15", or 18" Width

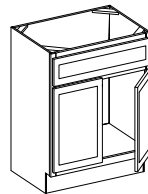

**Double Door**  
24", 27", 30", 33",  
or 36" Width

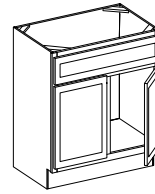

**Double Door  
Center Stile**  
42" Width

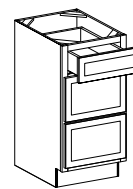

**Triple Drawer**  
12", 15", 18", or  
21" Width

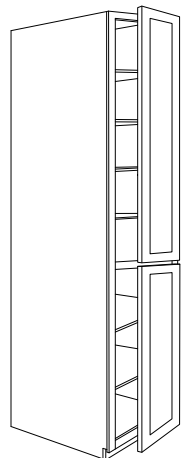

**Linen Single &  
Double Door**  
84" (6 shelves)  
Single: 15" and 18" Width  
Double: 24" Width

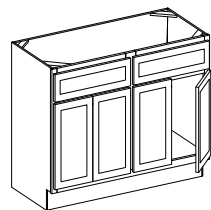

**Two Double Door**  
48" Width

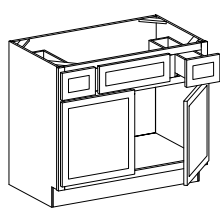

**Double Door and  
Double Drawer**  
36", 42", or 48" Width

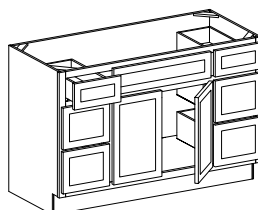

**Double Door and  
Six Drawer**  
60" Width

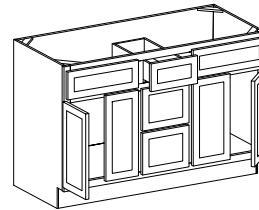

**Two Double Door and  
Triple Drawer**  
60" Width

# Complete the Look - Accessories

---

Add the finishing touch to your customer's cabinets with our broad selection of cabinet accessories. Whether your client's ideal space is traditional, transitional, or contemporary, we have the selection available to transform the space from ordinary to extraordinary.



---

## MOULDING

Crown, toe kick, light rail, scribe, and accent moulding options available

Available in all finishes:  
Polar White, Pebble Grey,  
Espresso & Slate

---

---

## OVERLAY FILLERS

Fluted and smooth options available

Available in all finishes:  
Polar White, Pebble Grey,  
Espresso & Slate

---





---

## DECORATIVE PANELS

Available in all finishes:  
Polar White, Pebble Grey,  
Espresso & Slate

---

---

## DECORATIVE WOOD

Available in all finishes & door styles:  
Polar White, Pebble Grey,  
Espresso & Slate

---



---

## SPECIALTY CABINETS

Available in all finishes:  
Polar White, Pebble Grey,  
Espresso & Slate

---



# Resources

## Assembly Videos



Base Cabinets  
[delivr.com/2s43x](https://delivr.com/2s43x)



Base Corner Cabinets  
[delivr.com/2r23p](https://delivr.com/2r23p)



Utility/Pantry Cabinets  
[delivr.com/29fgn](https://delivr.com/29fgn)

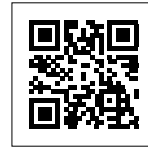

Double Oven Cabinets  
[delivr.com/28pgy](https://delivr.com/28pgy)

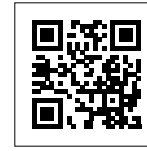

Wall Cabinets  
[delivr.com/25hbr](https://delivr.com/25hbr)

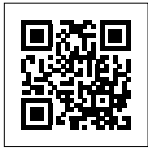

Wall Corner Cabinets  
[delivr.com/2d3s3](https://delivr.com/2d3s3)

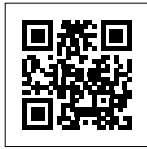

Wall End Cabinets  
[delivr.com/2krhy](https://delivr.com/2krhy)



Vanity Trim Kits  
[delivr.com/23n8d](https://delivr.com/23n8d)

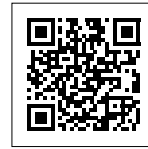

Cabinet Rollout Tray  
[delivr.com/2fzzv](https://delivr.com/2fzzv)

## NorthPoint Cabinetry Videos



NorthPoint Brand Overview  
[delivr.com/2nyhg](https://delivr.com/2nyhg)



Anatomy of a Cabinet  
[delivr.com/2zmba](https://delivr.com/2zmba)



Quick Advantage  
[delivr.com/2tuhn](https://delivr.com/2tuhn)



Quick Assembly  
[delivr.com/2kcwh](https://delivr.com/2kcwh)

## Literature & Samples

Available on the Resources section of our website.



Homeowner Catalog



Homeowner  
Selection Guide



Spec Book



Price Book

Also available:  
Touch Up Kits (not shown)



Mini Base Cabinets  
12" W x 21" H x 15" D



Sample Door Kit



Moulding Sample Kit



Finish Sample Kit

# Freestanding Selection Center

Make selection easy with a curated line of quality cabinets. Personalize cabinet designs with a wide offering of decorative & organization products.



- One cabinet in each door style
- Door samples with informational backers
- Moulding sample boards
- Marketing materials included—catalog, spec book, and homeowner brochure
- Trending matte black finish hardware from the Hayworth Collection by Jeffrey Alexander
- Optional add-ons for decorative hardware and organizers
- Some assembly required

**Ask your local sales representative about our display program and how to order a selection center for your showroom.**

# DESIGN TOOLS

NorthPoint Cabinetry products are available in ProKitchen and 2020 Design Software so that you have access to the right tools to create amazing spaces.



[www.ProKitchenSoftware.com](http://www.ProKitchenSoftware.com)



[www.2020spaces.com](http://www.2020spaces.com)



## Warranty

### Premier Collection

Hardware Resources warrants to the original consumer purchaser that our Premier Cabinetry will be free from unnatural defects in material and workmanship under normal use and proper care for the period of FIVE (5) YEARS from the date of original purchase. This Limited Warranty applies only to the Original Purchaser and is not transferable to any other party.

### Essentials Collection

Hardware Resources warrants to the original consumer purchaser that our Essentials Cabinetry will be free from unnatural defects in material and workmanship under normal use and proper care for the period of ONE (1) YEAR from the date of original purchase. This Limited Warranty applies only to the Original Purchaser and is not transferable to any other party.

For more details about warranty coverage, see our website, catalog, or price book.

Let us quote a full kitchen and **see the value!**

**NORTH  
POINT**  
CABINETS®

*hardware*  
**resources®**



To learn more about the quality accessories we offer or other products we manufacture visit [www.NorthPointCabinetry.com](http://www.NorthPointCabinetry.com), call 1-800-463-0660 or scan the QR code with your smartphone or mobile device.